

**Protects bearings from
contaminates.**

**Longer wear life and
more efficient than
standard bearing
isolators.**



7D's Bulwark bearing isolator kits (standard in new 7D pumps) are available to upgrade existing legacy equipment without the need for complex modifications, to deliver similar advantages of the complete SafeR™ bearing assembly.

The Bulwark Bearing Guard bearing isolator is a non-contacting, permanent bearing protection device.

Features and benefits

- ✓ **The recessed design** ensures dust, grime and mud do not sit on the top of the seal, damaging it over time.
- ✓ **A protective bearing isolator** improves maintenance intervals and reduces your inventory needs. The improved design catches lubricant in the inner section of the labyrinth and flows back to the bearing housing. External contamination is prevented from entering the bearing housing, caught in the outer labyrinth parts and released through a port in the stator by centrifugal force and gravity.
- ✓ **The splash guard** ensures even sustained high pressure gland leakage does not enter the bearing assembly.

Contact our technical team for videos and reports of the extensive test work conducted, providing confidence to claim superiority over competitor designs.

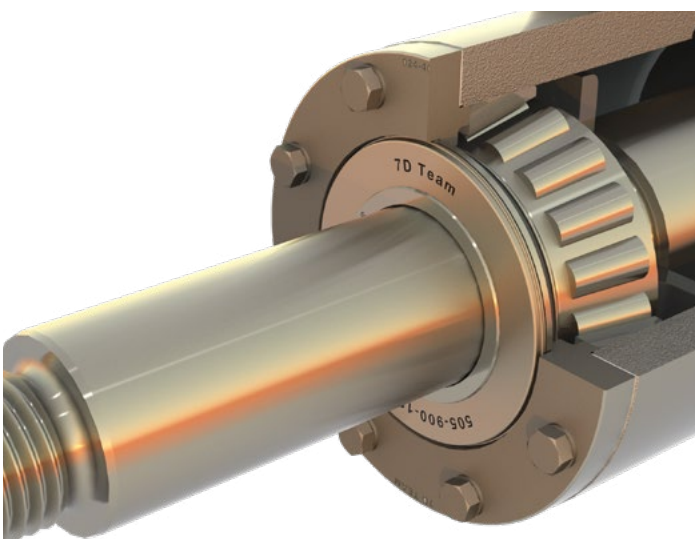

Stainless Steel Bulwark Bearing Guard in housing

Upgrading common brands

The table below shows the competitor part numbers upgradeable immediately to the Bulwark Bearing Guard.

Full bearing housings equipped with the Safer-Series bearing isolator technology can be purchased, alternatively, retrofit kits can be purchased to upgrade the existing 60 year old design.

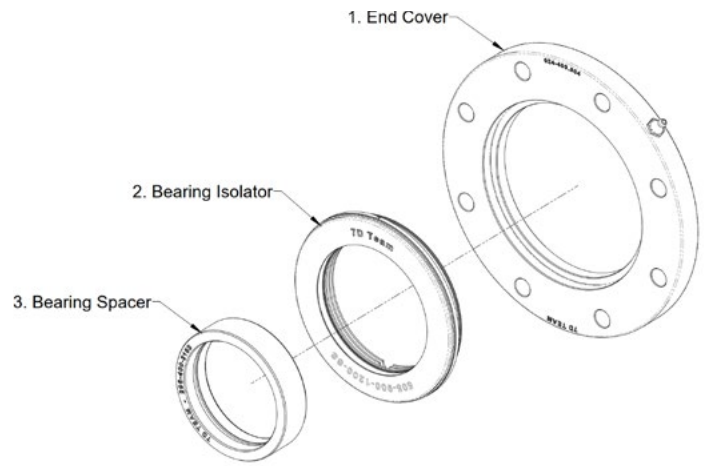

KITS TO UPGRADE COMMON HOUSINGS - READILY AVAILABLE STOCK

FRAME SIZE	UPGRADES FOR FRAME CODE	FULL BEARING ASSY	RETROFIT KIT	
			DE	NDE
B Housing	B005M	7D.005M.B	7D.K410.B	7D.K410.B
	B005XLM	7D.005M.B	7D.K410.B	7D.K410XL.B
C Housing	C005M	7D.005M.C	7D.K410.C	7D.K410.C
	C005XLM	7D.005MXL.C	7D.K410.C	7D.K410XL.C
	CC005M	7D.005M.CC	7D.K410D.CC	7D.K410.CC
	CC005XLM	7D.005MXL.CC	7D.K410D.CC	7D.K410XL.CC
D Housing	D005M	7D.005M.D	7D.K410.D	7D.K410.D
	D005XLM	7D.005MXL.D	7D.K410.D	7D.K410XL.D
	DD005M	7D.005M.DD	7D.K410D.DD	7D.K410.DD
	DD005XLM	7D.005MXL.DD	7D.K410D.DD	7D.K410XL.DD
E Housing	E005M	7D.005M.E	7D.K410.E	7D.K410.E
	E005XLM	7D.005MXL.E	7D.K410.E	7D.K410XL.E
	EE005M	7D.005M.EE	7D.K410D.EE	7D.K410.EE
	EE005XLM	7D.005MXL.EE	7D.K410D.EE	7D.K410XL.EE
F Housing	F005M	7D.005M.F	7D.K410.F	7D.K410.F
	F005XLM	7D.005MXL.F	7D.K410.F	7D.K410XL.F
	FF005M	7D.005M.FF	7D.K410D.FF	7D.K410.FF
	FF005XLM	7D.005MXL.FF	7D.K410D.FF	7D.K410XL.FF

UPGRADING METSO® FRAMES- READILY AVAILABLE STOCK

FRAME SIZE	FULL BEARING ASSY	RETROFIT KIT
Frame 250	7D-005-250	7D-K410-250
Frame 300	7D-005-300	7D-K410-300
Frame 400	7D-005-400	7D-K410-400
Frame 500	7D-005-500	7D-K410-500

MATERIALS SPECIFICATION

ITEM	DESCRIPTION	MATERIAL
1	End Cover	304 Stainless Steel
2	Bearing Isolator	Proprietary
3	Bearing Spacer	420 Stainless Steel
	O Rings	Viton



Full Safer-Series bearing housing featuring a Bulwark bearing isolator system